

- locuri de parcare - 4 / 50mp
- alee carosabila noua / asfalt - 20,00mp
- trotuare pietonal - 5,00mp
- lungime borduri mari - 30,00ml
- lungime borduri mici - 8,00ml

3 / 16mp
9,00mp
20,00ml
8,00ml
495950
389800

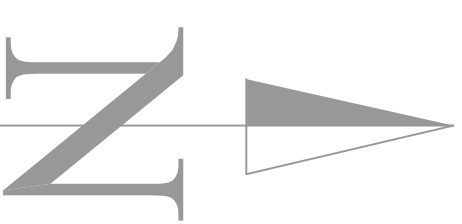
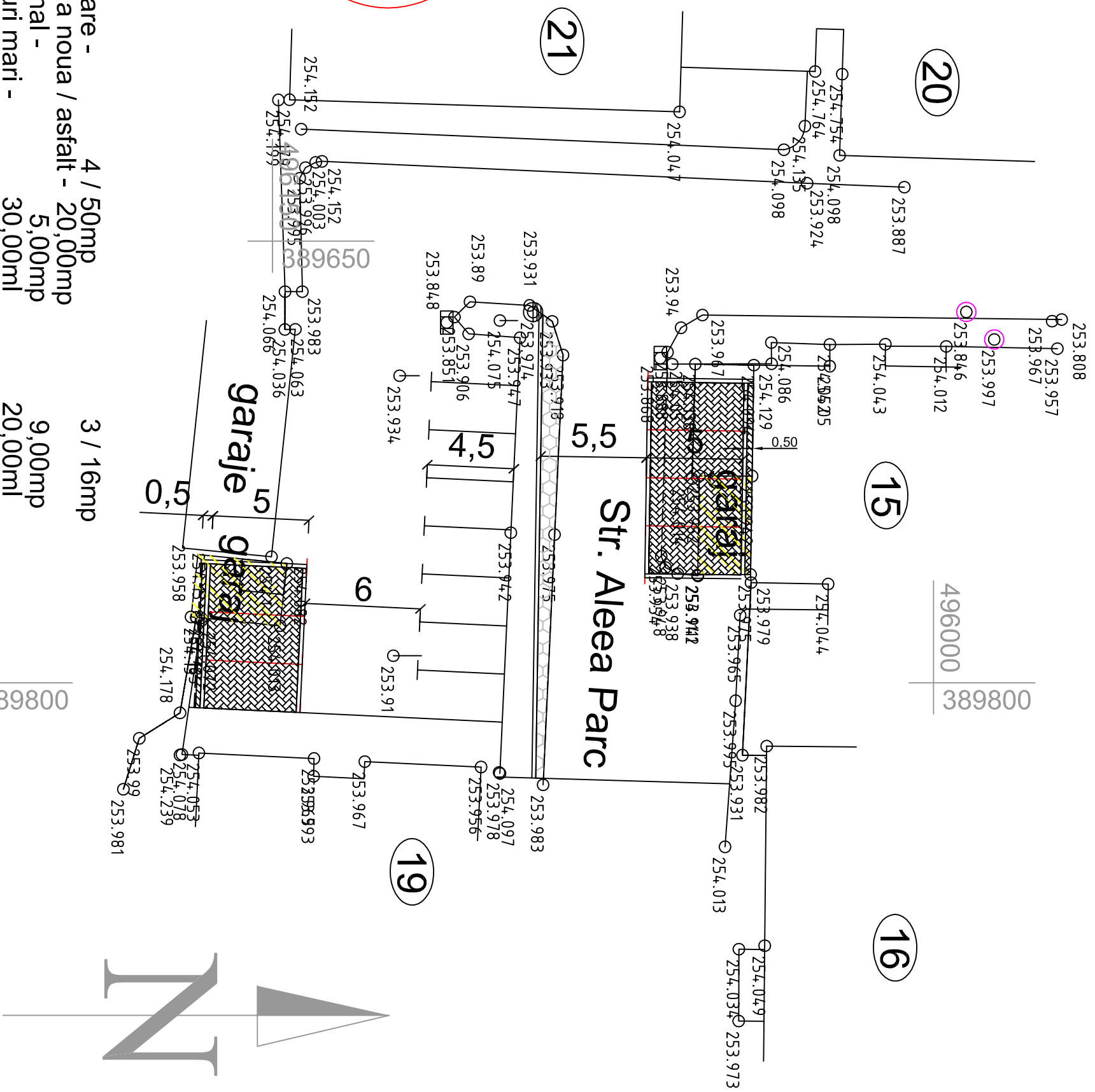

PROIECTANT ARHITECTURA : SC PROSERV PLUS SRL		Beneficiar: MUNICIPIUL SEBES	Proiect nr: 1532 / 2018
PROIECTANT GENERAL :		Sistemizare partiala a cartierelor : Valea Frumoasei, Aleea Parc si Aleea Lac, piin amenajarea de parcuri in zonele ocupate de garaje	Faza: SF
 SEND srl <small>proiectare structuri</small> 540554 Tigu-Mures, str. Plahului nr.1A/25 tel. 0365 980372; mob. 0721 824353 e-mail: lakatosm@yahoo.com		Zona 5- Aleea PARC	
SEF PROIECT	Ing. M. LAKATOS	PLAN DE DETALIU SI PROFIL CARACTERISTIC	SF 03.5
PROI. ARHIT.	ath. Dan FISUS		
PROI. TOPO	ing. Andras Meleg		
		Data: Nov.2018	Scara 1/250, 1/50